

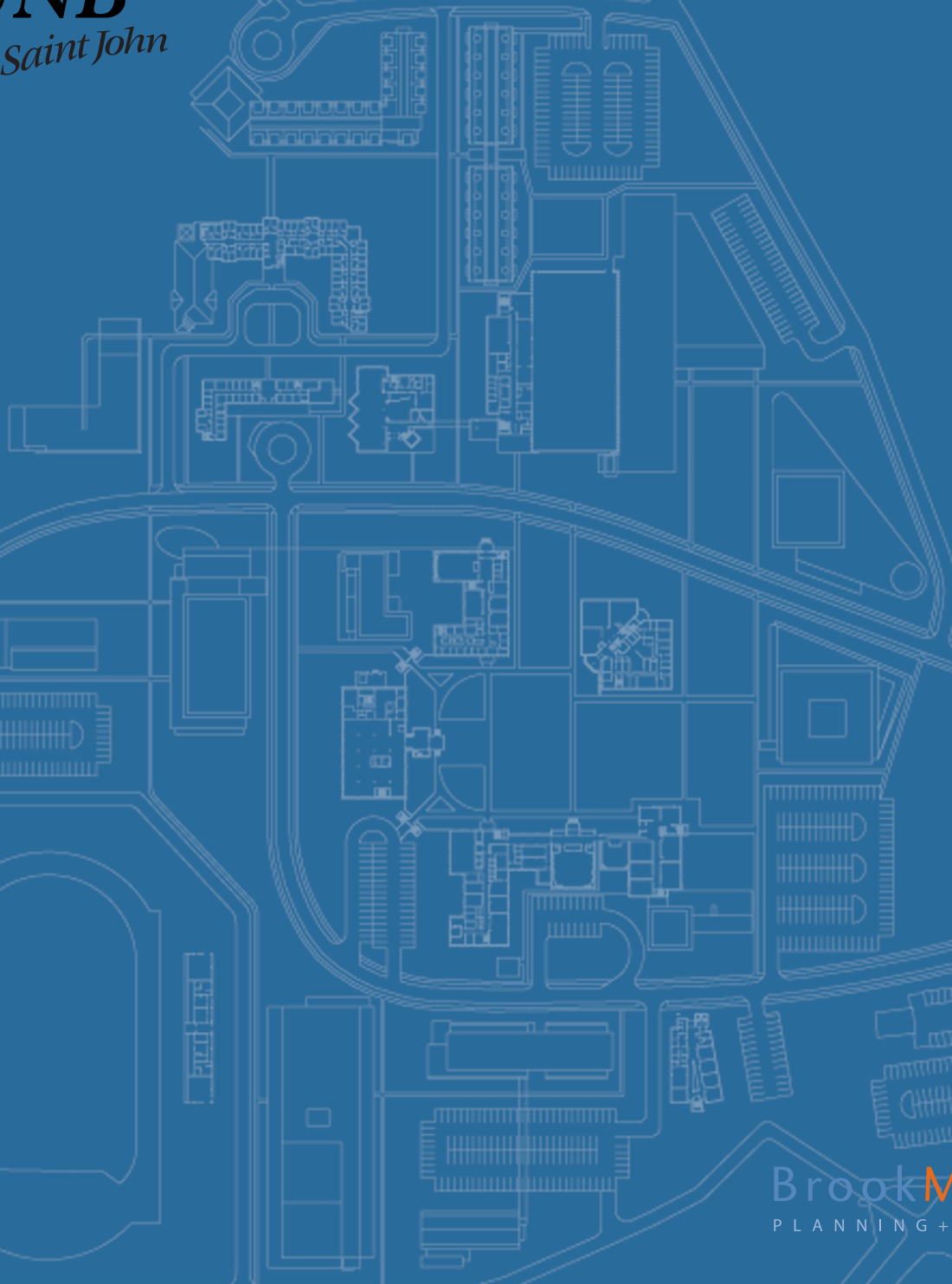

Saint John Campus Plan

University of New Brunswick



Final Draft
October 2004

BrookMcIlroy Inc
PLANNING + URBAN DESIGN



Saint John Campus Plan

University of New Brunswick

DRAFT FINAL

OCTOBER 2004

Brook McIlroy Inc.
planning + urban design

Acknowledgments

The University of New Brunswick at Saint John Campus Plan is the result of an intensely collaborative process that engaged a broad spectrum of the University and the Saint John community. This endeavour has brought to the fore a deep commitment to create at UNB Saint John a centre of excellence that is central to the future of New Brunswick while building a broader international reputation. The Campus Plan would not have been possible without the participation of the following individuals.

The Campus Plan was prepared under the overall leadership of Kathryn Hamer, Vice-President (Saint John) and the Properties Committee chaired by Wayne Squibb. The participation of the Board of Governors during the process of creating and refining the plan has been invaluable.

The Campus Plan focuses on both the creation of a long-term growth strategy as well as a detailed analysis of present day space needs. These dual objectives could not have been realized without the participation of a highly engaged group of people from the campus and the broader community who came together to form the Campus Plan Steering Committee. Their participation in workshops, visioning exercises and review of work-in-progress has been instrumental in shaping the plan. We are also indebted to Mike Ryan and Michael Baldwin (Campus Services and Planning) and Sarah deVarenne for their assistance throughout the campus planning process.

Additional consideration goes to the staff of UNB Saint John and UNB Fredericton who diligently provided data and information to the team throughout the process, particularly Lisa Carrier, Steve Ball and Margaret Murphy.

Steering Committee Members

Jim Baird	<i>Commissioner, Planning and Development, City of Saint John</i>
Chris Callbeck	<i>Assistant Vice-President (Financial & Administrative Services) Atlantic Health Sciences Corporation</i>
Michael Chisholm	<i>Director of Advancement - UNB Saint John</i>
David Emerson	<i>Student - UNB Saint John</i>
Ashley-Lynn Gautreau	<i>Vice-President (Saint John)</i>
Kathryn Hamer	<i>New Brunswick Museum</i>
Don McAlpine	<i>Associate Vice-President (Campus Services & Planning)</i>
Mike Ryan	

The Campus Plan for the University of New Brunswick Saint John has been prepared by Brook McIlroy Planning & Urban Design.

Anne McIlroy, Partner-In-Charge
Calvin Brook
Antoine Belaieff
Darlene Montgomery
Stacie Amo
Pei Zhao
Claire Ironside

Message from the President and Vice-President

Dear Friends,

The mission of the University of New Brunswick, our shared purpose, is transformation. As we elevate and expand the economic, cultural, and social prospects of our region and far beyond, we must also be prepared to reinvent ourselves and our institution. UNB Saint John retains its deep local roots, and has also developed an international focus and reach, bringing a world of opportunities to New Brunswick. Our collective future, as a province and as a university, is bright and full of promise, underscored by the aspirations and ambitions of students, our communities, and our many graduates.

The last forty years are testimony to the ability of the University of New Brunswick to match the pace of increasingly rapid change, and to thrive while doing it. Students, faculty, staff, and community have accomplished so much, transforming the 'sidewalk campus' of the 1960s into a vibrant community of scholars, research, athletic activity, and cultural leadership. In doing so, UNB Saint John has earned a reputation for innovation in programming, integrity in research, and for a network of partners and collaboration that spans the globe. The new plan for Tucker Park builds on this solid foundation by enhancing and focusing our learning environment, setting renewed standards for excellence and providing for growth.

The evolution of our programs, our teaching environment, and our research collaboration is imperative. This campus plan lays out a thoughtful and ambitious path for both UNB and Saint John. It should come as no surprise that this plan is an collaborative effort, and we extend our special thanks and appreciation to our partners at the City of Saint John, the New Brunswick Museum, and the Atlantic Health Sciences Corporation. The scope and ambition of this plan are evidence of the partnerships and cooperation we enjoy, and the singular relationship between town and gown that drives the success of this campus.

Thanks are due, as well, to the Properties Committee of the Board of Governors and its Chair, Wayne Squibb, for providing guidance and leadership for this plan. We are also indebted to Mike Ryan, Associate Vice-President for Campus Services and Planning; Mike Baldwin, Property Manager for Campus Services and Planning; Sarah DeVarenne, Project Administrator for the Vice-President (Saint John); members of the Steering Committee; and all those from the University community and the City of Saint John who participated in the planning process. To Calvin Brook, Anne McIlroy, Antoine Belaieff and the other members of the team at Brook McIlroy Inc, a sincere thank-you for a job well done.

This plan forms the basis for the decisions we make about the design, construction, and management of our facilities. We are committed to its implementation and to investing in the Saint John campus as the focus for growth in UNB in the coming years.

John McLaughlin
President & Vice-Chancellor

Kathryn Hamer
Vice-President (Saint John)

Summer 2004

Perspective of the proposed campus looking south.
The Hospital can be seen in the distance.

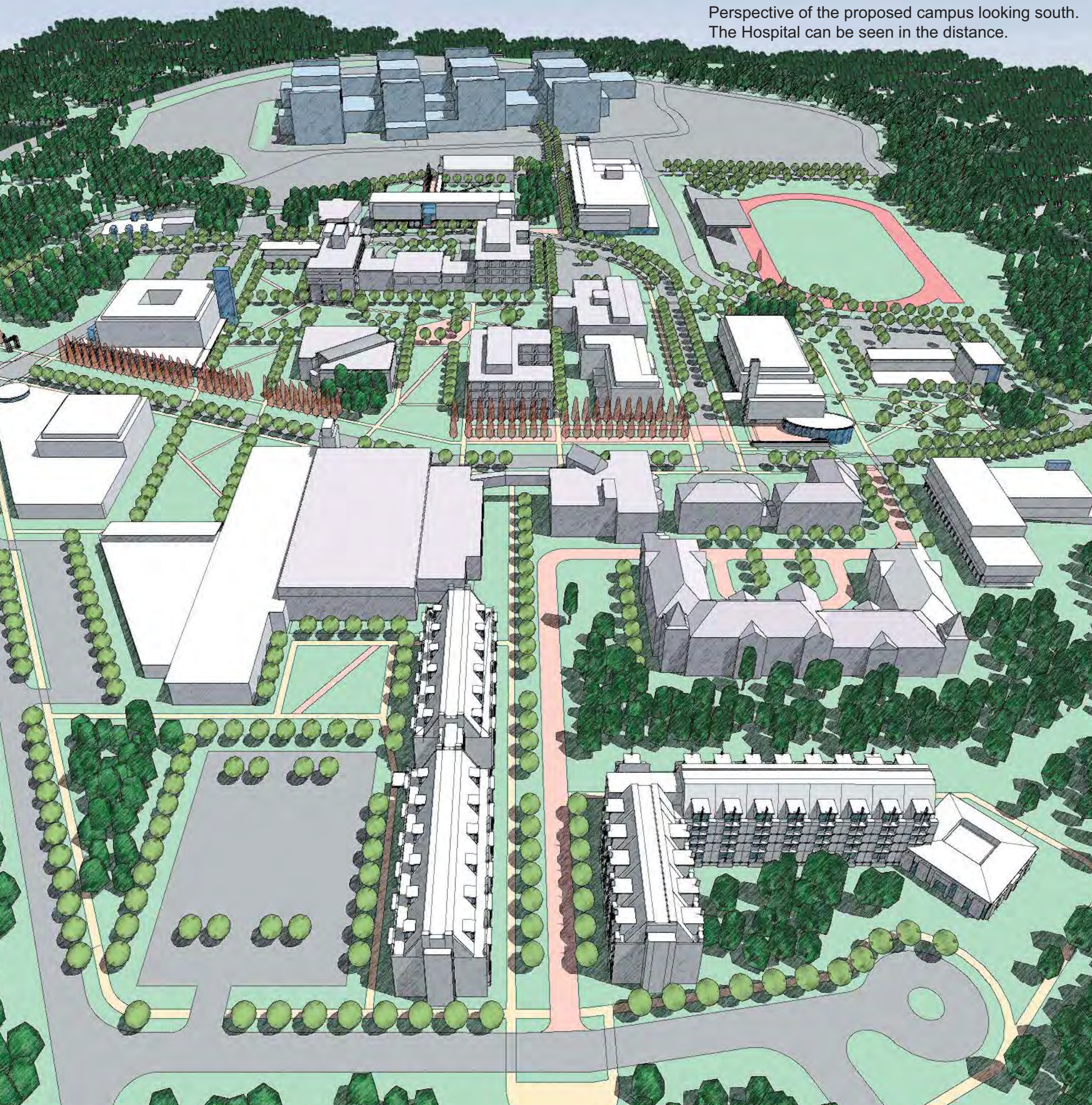

Preface

Over a forty year period, the University of New Brunswick at Saint John has come to occupy a prime spot on Tucker Hill, boasting a fast-growing student population of over 3,000 students. From humble beginnings in what was then called the "sidewalk campus" – because it occupied so many buildings scattered around uptown – UNB Saint John has grown to become a respected degree-granting institution attracting faculty and students from all over the world. Today, over a quarter of its students come from outside Canada, a unique characteristic among Atlantic universities.

Between 2000 and 2004, the student body grew by 26 percent, but during the same period, only the Modern Language Centre has been added to the supply of academic space. Since the construction of the Thomas J. Condon Student Centre in 1986, no new activity or communal space has been built on campus outside of the residences.

As UNBSJ has received the formal mandate to grow further, potentially to 5,000 students within the next ten years, the University will continue its ambitious capital campaign aimed at providing its students with first-rate facilities.

In 2001, the University of New Brunswick embarked on a strategic planning exercise aimed at evaluating all its land holdings and facilities across the province. Through this process, the need for Campus Plans for both the Fredericton and Saint John campuses became apparent. The Fredericton Campus Plan was completed in 2003 and is currently in its implementation phase. The Saint John Campus planning process began in late 2003 addressing different objectives than those provided for the Fredericton Plan. These included a survey of space resources available on campus and an analysis of their adequacy; concepts to help guide the future growth of the campus, and short-term recommendations to improve the appearance and functionality of indoor and outdoor spaces on campus.

In the Fall of 2003, a number of one-on-one interviews were held with faculty, staff and students to better understand the special assets of the Campus, its issues, concerns and the aspirations of the University Community. These extensive interviews provided the foundation on which the Plan has been built.

In February 2004, an interactive workshop was held on campus with a cross-section of the University Community. Groups of eight to ten participants debated guiding principles, key issues and provided the planning team with key directions for the Plan. In parallel, the Team met with the Steering Committee, composed of key stakeholders to provide helpful guidance to the Team.

A long-term Campus Concept Plan was presented at two Open Houses held on campus. On March 23, the first Open House presented preliminary concepts and opportunities. Based on the feedback received, a more detailed and refined concept was developed and presented at the second Open House on May 18. The second Open House also coincided with a formal presentation to the University's Board of Governors in Fredericton.

The Campus Plan strives to embody all the input and feedback received in person, over the telephone, by e-mail, through the interactive Campus Plan web site, and through the numerous questionnaires received from faculty, staff and students of the University. The Campus Plan proposes the creation of an integrated campus community with clear connections between old and new buildings, an environment for intellectual and social exchange promoting a sense of campus life and community by introducing new campus elements - recreational, entertainment, meeting, convenience retail and housing. In addition to ensuring that the physical environment is consistent with UNBSJ's identity and exciting new initiatives, the Campus Plan sees UNBSJ further reinforcing its role as a social, cultural and economic partner in Saint John, with its activities reaching out to the larger regional and global communities.

The Campus seen in its context, close to the Kennebecasis River and Millidgeville. The Hospital can be seen in the foreground.



Préface

En seulement quarante ans, l'Université du Nouveau Brunswick à Saint Jean (UNBSJ) a établi une présence sur son site de Tucker Hill et peut s'enorgueillir d'une population de plus de 3 000 étudiants. De ses origines modestes qu'on raillait de « campus dans la rue », parce qu'il occupait tant de bâtiments disparates au centre-ville, UNBSJ est devenue une institution respectée qui attire professeurs et étudiants du monde entier. Aujourd'hui, plus d'un quart de ses étudiants viennent de l'étranger, un atout unique parmi les universités des provinces atlantiques.

Entre 2000 et 2004, le corps étudiant a crû de 26%, alors que durant la même période, seul le Centre de Langues Modernes a été construit comme bâtiment à vocation académique. Depuis la construction du centre étudiant Thomas J. Condon en 1986, aucun espace social ou culturel n'a été construit en dehors des résidences universitaires.

UNBSJ a reçu le mandat formel de continuer à se développer et pourrait atteindre un total de 5 000 étudiants d'ici dix ans. L'Université va donc devoir continuer son programme immobilier ambitieux pour créer des aménagements de tout premier ordre en quantité adéquate.

En 2001, l'Université a commencé un exercice de planification stratégique visant à évaluer ses biens immobiliers au Nouveau Brunswick. Il est alors apparu que les campus de Fredericton et Saint Jean pourraient bénéficier de plans directeurs. Le plan pour le campus de Fredericton a été terminé en 2003 et se trouve maintenant dans sa phase de mise en œuvre. Pour ce qui est du campus de Saint Jean, le processus a commencé à la fin de 2003. Des objectifs quelque peu différents ont été mis en évidence pour ce plan directeur : une étude de la concordance entre les biens immobiliers disponibles et les besoins de l'Université pour mener sa mission à bien; des concepts pour guider la croissance future de l'Université et des recommandations à court terme pour améliorer l'apparence et la fonctionnalité des espaces intérieurs et extérieurs.

Durant l'automne 2003, des entretiens approfondis ont été menés à bien avec le corps professoral, des employés et des étudiants pour mieux comprendre les atouts du campus, ses problèmes, ainsi que les aspirations des usagers de l'université. Ces entretiens ont fourni une base solide sur laquelle le plan directeur a ensuite été développé.

En février 2004, un atelier interactif s'est tenu avec un éventail de participants. Des groupes de huit à dix participants ont discuté des principes de base et des problèmes clés à surmonter. Leurs discussions ont fourni les orientations majeures pour la suite de la préparation du plan. En parallèle, des rencontres ont eu lieu avec le Comité de Direction du plan, composé des intervenants les plus importants. Le comité a ensuite continué à intervenir pour guider l'équipe de préparation du plan directeur tout au long du processus.

Deux visites libres ont eu lieu sur le campus, lors desquelles des concepts ont été présentés afin de provoquer des réactions et obtenir des indices sur la voie à suivre pour la suite de la préparation du plan. Le 23 mars, des propositions préliminaires ont été présentées, pavant la voie à un concept plus développé qui a été montré lors de la seconde visite libre, le 18 mai. Cet événement a également coïncidé avec une présentation formelle au conseil des gouverneurs de l'Université du Nouveau Brunswick à Fredericton.

Dans sa forme finale, le plan directeur s'efforce de réunir toutes les informations et commentaires reçus personnellement par téléphone, par courrier électronique, par truchement du site interactif dédié au plan, ainsi que dans les nombreux questionnaires remplis par les enseignants, employés et étudiants de l'université. En plus de créer un environnement qui reflète l'identité nouvelle de l'université et ses nombreuses initiatives, le plan directeur propose la création d'un campus qui intègre harmonieusement bâtiments nouveaux et existants et crée un environnement propice aux échanges sociaux et intellectuels qui encourage l'émergence d'une riche scène universitaire. Ainsi, ce plan directeur contribuera à renforcer le rôle de l'Université comme pôle social, culturel et économique à Saint Jean et bien au-delà.

Contents

I. ANALYSIS AND DIRECTION	1
II. SPACE ANALYSIS AND RECOMMENDATIONS	15
III. THE CAMPUS PLAN CONCEPT	27
IV. CAMPUS OPEN SPACE	55
V. BUILT FORM AND ARCHITECTURAL CHARACTER	99
VI. IMPLEMENTATION AND PLANNING CONSIDERATIONS	121
APPENDICES	133